

DIN 929 Hexagon Weld Nuts

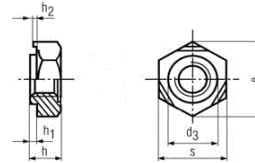

| DIN 929 Hexagon Weld Nuts | | | | | | | | | |
|---------------------------|------|------|------|-----|-----|-------|-----------|------|------|
| Thread | d3 | h1 | h2 | h | s | e | | Min. | Max. |
| M3 x 0.50 | 4.5 | 0.55 | 0.25 | 3 | 7.5 | 8.15 | Material | 0.63 | 2.6 |
| M4 x 0.70 | 6 | 0.65 | 0.35 | 3.5 | 9 | 9.38 | | 0.75 | 3 |
| M5 x 0.80 | 7 | 0.7 | 0.4 | 4 | 10 | 10.95 | | 0.88 | 3.5 |
| M6 x 1.00 | 8 | 0.75 | 0.4 | 5 | 11 | 12.02 | Thickness | 0.88 | 4 |
| M8 x 1.25 | 10.5 | 0.9 | 0.5 | 6.5 | 14 | 15.38 | | 1 | 4.5 |
| M10 x 1.50 | 12.5 | 1.15 | 0.65 | 8 | 17 | 18.74 | | 1.25 | 5 |
| M12 x 1.75 | 14.8 | 1.8 | 0.8 | 10 | 19 | 20.91 | | 1.5 | 5 |
| M14 x 2.00 | 18.8 | 1.8 | 1 | 11 | 22 | 24.27 | | 2 | 6 |
| M16 x 2.00 | 18.8 | 1.8 | 1 | 13 | 24 | 26.51 | 2 | 6 | |

Material Steel Self Colour

INFORMATION AND DRAWINGS PROVIDED ARE REFERENCE ONLY